



**CLEMCO**  
The Performance  
System

## TECHNICAL DATA SHEET

*Note: For safe, efficient blasting, read and follow the owner's manual and seek training for everyone who will use this equipment.*

### Purpose

The Apollo 600 HP is designed for use with compressed air. It meets OSHA standards for respiratory protection and air noise limitations. The Apollo 600's full-helmet design protects the blast operator's head from rebounding abrasive and from job-site impact hazards.

The heavy-duty silver-grey cape protects the operator's neck, shoulders, and chest from rebounding abrasive.

### Requirements for Operation

- Source of Grade D or better quality compressed breathing air, as defined by the Compressed Gas Association specification G-7.1
- Volume of compressed air for breathing: 15 cfm at 65 to 100 psi when using ACV; or 20 cfm at 90 to 100 psi when using Clem-Cool, CAT or CCT
- A breathing-air filter, such as Clemco CPF, to remove oil mist, moisture, particles, and odors
- Protective clothing, hearing and eye protection

### Description of Operation

The Apollo 600 is a single-shell helmet with two adjustable suspension options. The DLX comfort-fit suspension (2 sizes) surrounds the operators head with comfortable padding. The adjustable web suspension fits head sizes 6.5 to 8. Adjustable chin strap holds the helmet in position on the operator's head.

The wide, full-view window provides an expansive field of vision. A series of lenses preserves the operator's clear view of the work surface and protects the operator from dust and abrasive in the ambient air. A replaceable fixed inner lens securely fits inside a molded rubber gasket. An intermediate lens protects the inner lens; and up to 3 tear-away (perforated) outer lenses complete the system. The tear-away lenses are removed one at a time to expose a clean lens beneath. The multi-lens system is held in place by a hinged frame with replaceable latch.

### Description

The Apollo 600 HP is a type CE, continuous-flow, supplied-air respirator as defined by the National Institute for Occupational Safety and Health (NIOSH) for abrasive blasting to be used with a respirable compressed air source. The Apollo 600 is high-visibility red and offered with two suspension options.



To suit differing customer needs, the respirator is available in several configurations with one of the following air control devices:

- Constant-flow Connector (CFC) – fixed air flow
- Air-control Valve (ACV) – adjustable air volume
- Cool-air Tube (CAT) – cools incoming breathing air
- Climate-control Tube (CCT) – heats and cools incoming air

All breathing-air valves have minimum and maximum flow points as specified by NIOSH.

A flexible breathing tube maintains air flow between the inlet fitting on the operator's belt and a replaceable inlet fitting at the center rear of the helmet crown for maximum operator comfort and maneuverability. The tube contains specially-formulated sound-deadening materials to reduce noise levels of incoming air to 80 dBA.

The helmet is generously sized to allow ear plugs or ear muffs and safety glasses or goggles as needed.

Incoming air enters the system through the air control device on the operator's belt. It continues through the breathing-air tube to enter the helmet at the inlet fitting at the center rear of the helmet crown. An air-distribution channel guides air over the head to the operator's face.

## Apollo 600 HP Supplied-Air Respirators

for use with compressed  
air supply

The incoming air to the respirator system maintains positive pressure inside the helmet. Exhaled air exits through the knit collar, which must fit snugly around the operator's neck. All helmet features work together to protect the operator from exposure to harmful dust and abrasive.

### Advantages

- Two suspension options: web-style or DLX comfort-fit style
- Expansive, 180° full-view window
- Multi-lens system with rugged, positive-latching window frame
- Built-in mini visor prevents media ingress between lenses
- User-friendly cape attachment system
- Zip-in-and-out washable inner collar
- Replaceable inlet fitting
- Replaceable window latch
- Generous interior dimension allows supplementary hearing and eye protection
- Optional rectangular lens

### Approvals and Certification

The Apollo 600 HP is NIOSH-approved as a type CE, continuous-flow supplied-air respirator; approval number: TC-19C-130. The respirator is recognized by OSHA as having an assigned protection factor (APF) of 1000 times the permissible exposure limit (PEL) for lead dust. It also meets the American National Standards Institute (ANSI) requirement for industrial head protection as stated in ANSI 289.1-2003 as a Type I, Class G protective helmet.

**NOTE:** Prior to use, ensure that the Apollo, type CE, supplied-air respirator is appropriate for your specific blasting conditions and requirements.

## Respirator Systems and Accessories

Item Description	Stock No.	
Apollo 600 HP	DLX Suspension	Web Suspension
Less Respirator Hose		
With CFC .....	25190	24001
With ACV .....	25191	24002
With CAT .....	25192	24003
With CCT .....	25193	24004
With Clem-Cool .....	25194	24932
With 50 ft x 3/8" Respirator Hose		
With CFC .....	25200	24771
With ACV .....	25202	24210
With CAT .....	25204	24211
With CCT .....	25206	24212
With Clem-Cool .....	25208	24933
With 50 ft x 3/8" Respirator Hose and CPF-20 Filter		
With CFC .....	25201	24772
With ACV .....	25203	24213
With CAT .....	25205	24214
With CCT .....	25207	24215
With Clem-Cool .....	25209	25299

## Options and Accessories

Constant Flow Connector with belt .....	21422
Cool-Air Tube with belt .....	04410
Clem-Cool Air Conditioner with belt .....	23825
Climate Control Tube with belt .....	04411
CPF-20 filter (for 1 to 2 operators) .....	03578
CPF-80 filter (for up to 4 operators) .....	03527
Carbon monoxide alarm, stationary CMS-1 .....	23017
Carbon monoxide alarm, portable CMS-2 .....	22894
Heavy-duty blast suit (leather front, cotton back)	
S      M      L      XL      XXL      XXXL	
08920 08921 08922 08923 24201 24202	
Light-weight seasonal blast suit (nylon front, cotton back)	
S      M      L      XL      XXL      XXXL	
22913 22914 22915 22916 22917 25022	
Leather gloves .....	02243
Comfort Vest with Clem-Cool .....	25266
Low pressure conversion kit	
Converts HP helmet to LP helmet .....	24812
Noise reduction ear muffs .....	23886
Outer lens, rectangular, .015" (pk of 25) .....	24005

## Shipping Dimensions and Weights

Apollo 600 Respirator, 14-1/2 x 13 x 15 .....	9 lbs
50 ft x 3/8" Respirator Hose, 12 x 12 x 5 .....	7 lbs
CPF-20 Breathing-air Filter, 21 x 20 x 10 .....	21 lbs

Authorized Distributor:

## Replacement Parts

Item Description	Stock No.
1. Constant-flow connector, HP (alternate), without belt .....	21415
2. Belt, 2" web with buckle .....	04430
3. Respirator hose, 3/8" x 25 ft. (alternate), includes items 6 and 7 .....	04397
4. Respirator hose, 3/8" x 50 ft. (alternate), includes Items 6 and 7 .....	04415
5. Respirator hose, 3/8" x 100 ft. (alternate), includes items 6 and 7 .....	04398
6. Adaptor, 3/8" hose to 3/8 NPT .....	00022
7. Union, 3/8" hose to 3/8" hose .....	01020
8. Disconnect, 1/4 NPT female .....	00025
9. Adaptor, 3/8" hose to 1/4 NPT .....	01019
10. Acoustical foam kit, both sides	
Not used with padded suspension .....	04369
11. Gasket, window .....	23819
12. Inner lens, .040", package of 5 .....	04367
13. Outer lens, .0075", perf'd, package of 25 .....	04361
14. Intermediate lens, .020", package of 5 .....	24943
package of 25 .....	04373
15. Window frame assembly .....	24012
16. Chin strap .....	04460
17. Handle strap .....	03623
18. Cape attachment band .....	23801
19. Outer lens, .015", rectangular package of 25 .....	24005
20. Cape, grey, includes item 23 .....	23818
21. Breathing tube assembly w/ (2) item 22 .....	22811
22. O-ring, 7/8" OD, 2 required .....	22815
23. Inner collar .....	08740
24. Latch kit, window frame	
includes base, screws and nuts .....	24006
25. Inlet fitting, breathing tube .....	23804
26. Chin strap holder kit (2 w/ fasteners) .....	24008
27. Partition, air baffle .....	23811
28. Clips, suspension (pack of 4) .....	24773
29. Sweatband, used with item 30 .....	23817
30. Web suspension with sweatband (alternate) .....	23802
31. DLX padded suspension kit (alternate)	
includes items 27 and 32 thru 36 .....	25189
32. Pad, top .....	25181
33. Suspension web (for DLX only) .....	25184
34. Pad, middle .....	25182
35. Pad, side	
black/grey fits most head sizes .....	25183
black/blue for smaller head sizes .....	25187
36. Hook-fastener tape, 1" adhesive backed, 3-ft. used, specify feet required .....	25185
Apollo 600 HP Owner's Manual .....	23930

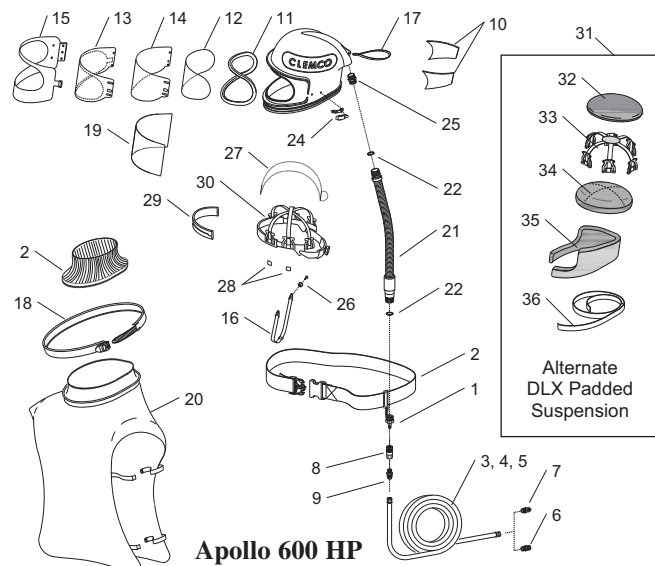

ISO 9001:2000 certified. Clemco is committed to continuous product improvement. Specifications are subject to change without notice.

© 2009 Clemco Industries Corp. • One Cable Car Drive • Washington, MO 63090 • Phone (636) 239-4300 • Fax (800) 726-7559

Stock No. 24181

www.clemcoindustries.com

Job No. 1195-1295 • Rev. D 04/09